

Model No.: SMA-KE-P901

Material: brass with gold-plated surface

SMA-KE male straight head (180 degrees) - external screw type, internal pin, half thread – P type offset 4 feet

1. Electrical Characteristics

- 1.1 Impedance: 50 Ohm
- 1.2 Working Frequency: DC-3 GHz
- 1.3 S.W.R.: ≤1.5
- 1.4 Working Voltage: 335V/ Max
- 1.5 Insulation Resistance: 5000 Mohm
- 1.6 Contact Resistance: Center contact: 3 Mohm
- 1.7 External contact: ≤2 Mohm

2. Work Environment

- 2.1 Operating Temperature Range: -55°C ~ +125°C
- 2.2 Salt Spray Test: 48H

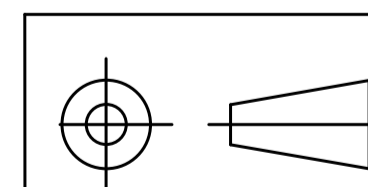

**DreamLNK**® 深圳市骏晔科技有限公司  
SHENZHEN DREAMLNK TECHNOLOGY CO., LTD

Tolerance 未注公差		Part Name. 品名	SMA-KE-P903	
.X ±0.2		Material. 材		
.XX ±0.10		Finish. 理		
.XXX ±0.05		Scale. 比例	1:1	Draw .
未注角度公差 ±1°		REV. 版本/次	A/0	Check. 核
		Unite. 位	mm	App. 核准
			2019.10.18	2019.10.18
				2019.10.18

3	PIN OD1.40*11.50	Brass with gold-plated surface 2u"	SMA014115G-4001	1
2	Insulator OD4.18*6.00	PTFE White	SMA418060I-1747	1
1	Screw thread SQ6.35*11.40	Gold-plated 2.5u"	SMA635114G-4000	1
Item No.	Part Name/Specification	Material	Part No.	QTY.